

HYPHERPRO

STEERING DAMPER MOUNTING KIT

for VOXAN Cafe Racer Model 2000 ->

MK-VO10-S001 PART LIST

SD stroke 140	1	M6x16	2
Tube Clamp TYPE 1	1	M8x35 Button head	1
O-Ring	2	M8x45 Button head	1
Fork Clamp ϕ 54	1	-	-
CNC Frame Bracket	1	-	-
Spacer Type 1	1	-	-
Spacer D14d8.5h20	1	-	-
-	-	-	-

ALL IDEAS, DESIGNS ARRANGEMENTS AND PLANS INDICATED OR REPRESENTED BY THIS DRAWING ARE OWNED BY HYPERPRO AND WERE CREATED, EVOLVED AND DEVELOPED FOR USE ON AND IN CONNECTION WITH THE SPECIFIC PROJECT. NONE SUCH IDEAS, DESIGNS, ARRANGEMENTS OR PLANS SHALL BE USED BY OR DISCLOSED TO ANY PERSON, FIRM OR CORPORATION FOR ANY PURPOSE WHATSOEVER WITHOUT THE WRITTEN PERMISSION OF HYPERPRO.

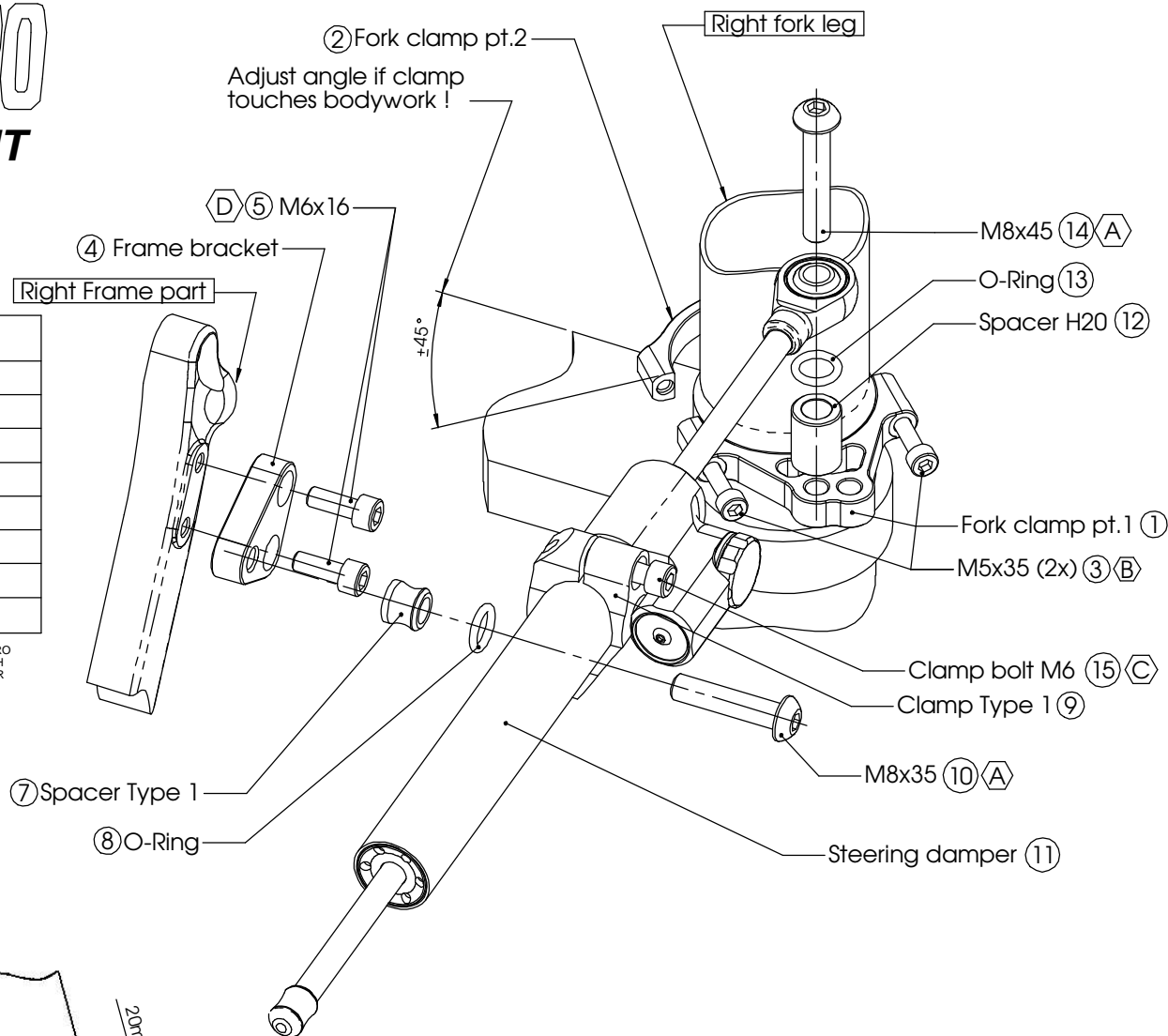

DAMPING ADJUSTER KNOB:
 - turn CW to increase damping
 - turn CCW to decrease damping
 NEVER USE MAXIMUM SETTING !!!

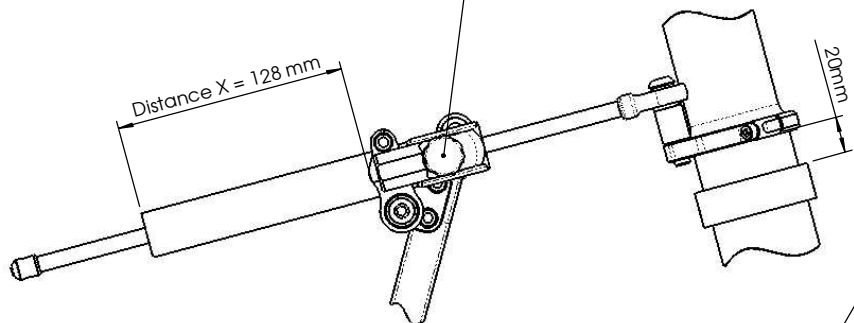

1
of 2

A	14-17Nm / 124-150Lbs.In / 10.3-12.5Lbs.Ft	C	6Nm / 53Lbs.In / 4.4Lbs.Ft
B	8Nm / 70Lbs.In / 5.9Lbs.Ft	D	5-9Nm / 44-80Lbs.In / 4.0-6.4Lbs.Ft

See WWW.HYPERPRO.COM for the latest pictures, modifications, specs. and e-drawings of this steering damper kit.

HYPERPRO

STEERING DAMPER MOUNTING KIT

for

VOXAN Cafe Racer Model 2000 ->

MK-VO10-S001 INSTALLATION INSTRUCTIONS

In general:

HYPERPRO can not be held responsible in any way for any form of physical, material, financial or other damage arising from use, assembly or overhaul of HYPERPRO products.
HYPERPRO reserves the right to make changes without prior notice.

This product is ONLY TO BE INSTALLED BY A PROFESSIONAL MECHANIC.

This product is only to be used for the motorcycle brand, model and year stated specifically on top of the pages of this manual.

DO NOT attempt to install this product on motorcycles from any different brand, model and/or year than stated on the pages of this manual.

DO NOT use this kit for cars, boats, jet-skies, snowmobiles, ATV's, aircraft, hovercrafts or any other vehicle and/or purpose.

HYPERPRO steering dampers are FOR RACE USE ONLY, NOT FOR HIGHWAY USE!

Before installation:

- Please read the entire manual carefully before starting the installation!
- Check if you have all the tools required. Good tools are a must.
- Protect your bike at the most important places in and around the work area (e.g. tank, fairing, frame, etc.) with a blanket, towel or similar.

During installation:

- Check all operations and parts carefully before, during and after performing each step.
- Clean all surfaces that are required for fitting parts together or for applying self adhesives or loctite, thoroughly with contact cleaner or another degreaser, unless otherwise stated.
- Be careful not to damage or scratch any part of your bike.
- ALWAYS work relaxed and concentrated!! It is very easy to damage something or make a mistake.

After installation:

- Check and make sure that there is no contact between any part of the steering damper kit and any part of the motorcycle. The kit should not hit anything. Steering movement should not be limited by the steering damper. If the steering movement is limited, adjust the position of the tube in the clamp until steering movement is normal again. Do not forget to tighten the clamp bolt again!
- ALWAYS check the steering movement and feeling before each ride !
- FIRST RIDES: Start with the damper turned fully open (turn adjuster knob fully counter clockwise). Start adjusting in between rides with steps of MAX. 2 CLICKS (0.25 TURN) EACH TIME, until the damper is working satisfactory for your riding style.
- NEVER USE MAXIMUM SETTING, ALWAYS OPEN AT LEAST 2 CLICKS (0.25 TURN).

- WARNING ! DAMPER HAS AN ACTIVE / SPEEDSENSITIVE DAMPING SYSTEM;
 - Steering with NORMAL MOVEMENT should be FREE !!
 - Steering with FAST MOVEMENT should be CONTROLLED BY DAMPER !!
- HYPERPRO uses a special seal to reduce friction. The seal uses an oil film to work properly. It is normal that some oil can appear on the pistonrod.
- Damper works with oil: DAMPING CAN BE HARDER AT LOWER TEMPERATURES!

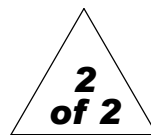

Remove the hose clamp from the right side, underneath the bodywork

Remove the two M6 bolts from the clamp. As the plate will not be used in combination with the steering damper, make sure during fitment that the hoses run OVER the damper.

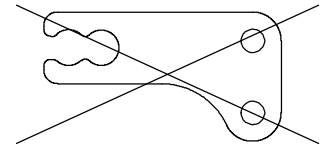

Step 1: installing the fork bracket

- Fork bracket, 2 parts + bolts (1, 2, 3)

Make sure that the right fork leg is clean and degreased. Remove the M5x35 bolts (3) from the fork bracket. Place part 1 (1) and part 2 (2) around the right fork leg, use the M5x35 bolts (3) to clamp the parts around the fork leg. Make sure that the 2 M8 holes are positioned correctly. Position the clamp at an angle of 45° and a distance of 20mm from the lower triple clamp, as shown in the pictures on page 1.
Tighten the bolts with a torque of approx. 8Nm/70Lbs.In/5.9Lbs.Ft

Step 2: installing the frame bracket

- Frame bracket (4)
- Bolt M6x16 (5, 6)
- Spacer Type 1 (7)
- 1x O-Ring (8)
- TubeClamp TYPE 1 (9)
- Bolt M8x35 Button head (10)

Fit the frame bracket to the frame, using the 2 M6 bolts (5 & 6) to mount it to the 2 original M6 bolt holes (in the front right engine & radiator mounting frame). Tighten them with a torque of approx. 5-9Nm/44-80Lbs.In/4.0-6.4Lbs.Ft.

Pre-assemble the tube clamp (9) and the steering damper (11) as shown on page 1. Set Distance X (=128mm) and tighten the M6 clamp bolt (15) with a torque of approx. 6Nm/53Lbs.In/4.4Lbs.Ft.

Put the rest of the assembly together as shown on page 1:

place the spacer (7), the O-ring (8) and the tube clamp (9) inline on top of the M8 hole and put the M8 bolt (10) through all the parts and screw it into the thread of the frame bracket. Tighten the bolt with a torque of approx. 14-17Nm/124-150Lbs.In/10.3-12.5Lbs.Ft.

Step 3: final installation

- Steering damper (11)
- Spacer D14 d8.5 h20 (12)
- 1x O-ring (13)
- Bolt M8x45 button head (14)

Move the damper bearing head (11), until the ball joint can be fitted to the fork clamp. Use the spacer (12), O-ring (13) and M8 bolt (14) to fixate the balljoint to the fork clamp and tighten with a torque of approx. 14-17Nm/124-150Lbs.In/10.3-12.5Lbs.Ft.

Check if the damper is level horizontally and aligned to the bike. Check if the damper does not touch anything when steering from left to right. Check if the bike can make it's full steering angle from left to right.

See WWW.HYPERPRO.COM for the latest pictures, modifications, specs. and e-drawings of this steering damper kit.