

## KAWASAKI ZX-10R 16- STREET SPORTS TYPE-R SLIP-ON R-11 SINGLE EXIT



Be sure to read the instruction carefully before starting the work. It is necessary to follow the contents to install Yoshimura product.

### 1. Product Information:

Description	KAWASAKI ZX-10R 16- Street Sports TYPE-R Slip-On R-11 Single Exit		
Part Number	Satin Finish Sleeve (SSF) : 170-289-5E30	Cyclone Type	K289S11C2
	Metal Magic Sleeve (SM) : 170-289-5E20	Main Material	Stainless steel
	Titanium Blue Sleeve (STB) : 170-289-5E80B	Weight [STD : 6.7kg]	(SSF) & (SM) : 2.9kg (STB) : 2.7kg

### 2. Applicable Model :

Model	Engine Type
KAWASAKI ZX-10R 16-	ZXT00JE

### 3. Contents:

No.	Descriptions	Part No.	Q'ty	No.	Descriptions	Part No.	Q'ty
1	Racing Mid Pipe	185-289-5E50	1	7	Button Bolt M6x20	803-206-4020	2
2	Silencer Assy, Satin Finish Sleeve	186-289-5E30	1	8	Washer M6x13	812-206-1310	2
	Silencer Assy, Metal Magic Sleeve	186-289-5E20		9	Flange Nut M6	823-006-1000	2
	Silencer Assy, Titanium Blue Sleeve	186-289-5E80B		10	Exhaust Spring	118-001-0000	1
3	Silencer Bracket	161-289-0200	1	11	Cap Bolt M10x60 P1.5	800-210-6060	1
4	Cap Bolt M8x40	800-208-5040	1	12	Washer M10x22	812-110-2216	2
5	Washer M8x26	812-108-2600	2	13	Flange Nut M10 P1.5	823-010-1500	1
6	Flange Nut M8	823-008-1250	1				

### Parts Diagram

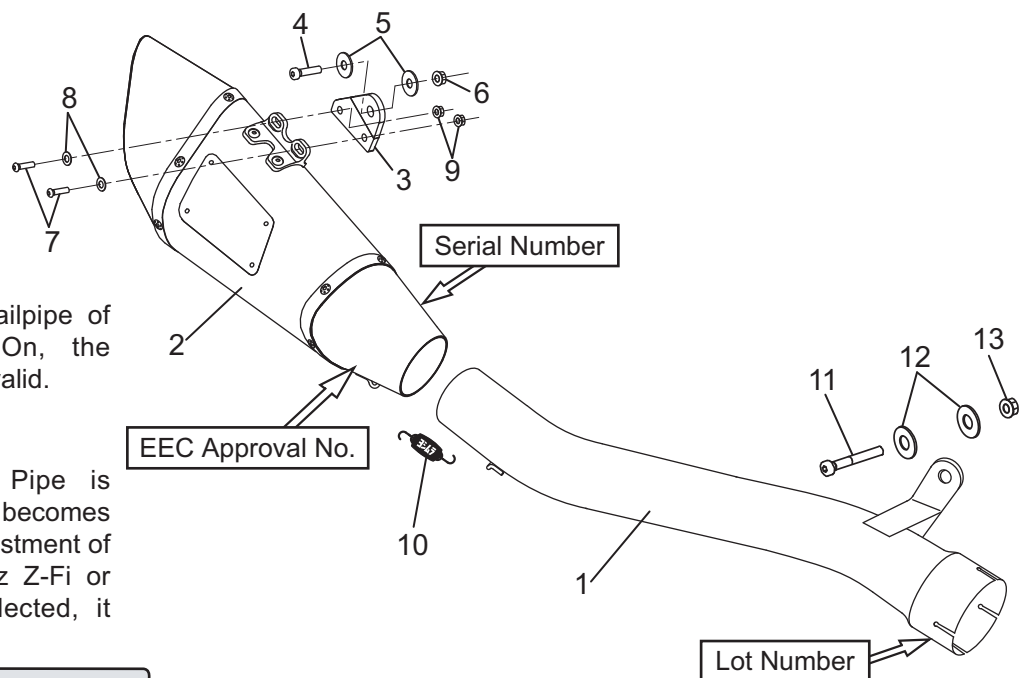

#### ⚠ CAUTION

In combination with the Tailpipe of this Street Sports Slip-On, the silencer EEC Approval is invalid.

#### ⚠ DANGER

When this Racing Mid Pipe is installed, the exhaust gas becomes leaner. It requires the readjustment of injection setting by Bazzaz Z-Fi or similar equipment. If neglected, it may cause engine damage.

⚠ Note and record the weight of silencer assy before installation for inner wool maintenance.