



YOSHIMURA

RESEARCH&DEVELOPMENT OF AMERICA, INC.

5420 DANIELS STREET STE A, CHINO CA., 91710 · (800) 634-9166 · (909) 628-4722 · FAX (909) 591-2198

www.yoshimura-rd.com

Enduro Series

Qualified Manufacturer Declared "Replacement Part"

**2001~2003
Honda XR100R**

**2004~2013
Honda CRF80/100F**

**2265503 (SS/AL)
TRS Stainless Steel Full-System**



Enduro Series systems are:

- Equipped with USFS-approved spark arrestor.
- CARB/EPA tail-pipe emissions compliant.
- All applications are marked with appropriate EPA noise labels.
- Have not been tested for EPA new vehicle noise compliance.



You must know how to remove and replace your stock exhaust in order to install this product otherwise have it installed by a professional mechanic. Keep all stock parts from your existing system as some components may be necessary to install your new Yoshimura exhaust depending on the application. Read through all instructions before beginning installation. Exhaust system can be extremely hot. Let motorcycle cool down before beginning installation. Always wear hand and eye protection and take precautionary measures to avoid injury.



NOTE: IN THE STATE OF CALIFORNIA, IT IS ILLEGAL TO MODIFY THE EMISSION CONTROL SYSTEM, WHICH INCLUDES THE CARBURETORS OF ANY VEHICLE.

Caution: Exhaust system can be extremely hot. Let motorcycle cool down before beginning installation.

Note: Read through all instructions before beginning installation.

Installation Steps:

1. Remove right rear number plate. (See Fig. 1)
2. Remove stock exhaust system and exhaust port gaskets.
3. Install new exhaust port gasket. (Honda part no. 18291-KZ1-670)
4. Install supplied rubber grommet into muffler mount. Insert aluminum spacer into rubber grommet (ensure shoulder of spacer faces toward frame) (See Fig. 3).
5. Install Yoshimura header & muffler assembly. Install stock header nuts finger tight. Install stock chassis mount bolt finger tight. (See Fig. 2) Install muffler mount with supplied bolt and washer finger tight (use the front muffler mount position). Adjust system to obtain correct alignment.
6. Torque header nuts to 2.0 kg-m (14.6 lb-ft).
7. Torque chassis mount bolt to 2.5 kg-m (18 lb-ft).
8. Torque muffler mount bolt to 2.5 kg-m (18 lb-ft).
9. It is recommended that the muffler and tailpipe be wiped down with rubbing alcohol to remove oil and fingerprints. This will help prevent tarnishing of the finish after the exhaust is heated up.
10. Check for proper clearance between new exhaust system and rear suspension (i.e. tire, swing-arm, brake, etc). If any problem is found, please carefully follow through the installation steps again. If problem still persists, please call Yoshimura Technical Department at (800)634-9166 / in CA (909) 628-4722
11. Reinstall number plate.
12. Check for proper clearance between new exhaust system and number plate.

NOTE: After starting motorcycle, it is normal for new exhaust system and muffler to emit smoke until oil residue burns off.

Tools Needed:

8mm, 10mm, and 12mm sockets
Ratchet and extension
Torque wrench
4mm allen wrench



Fig. 1



Fig. 2

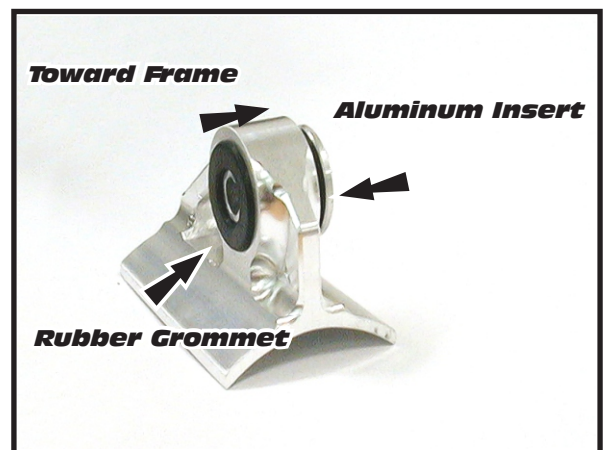
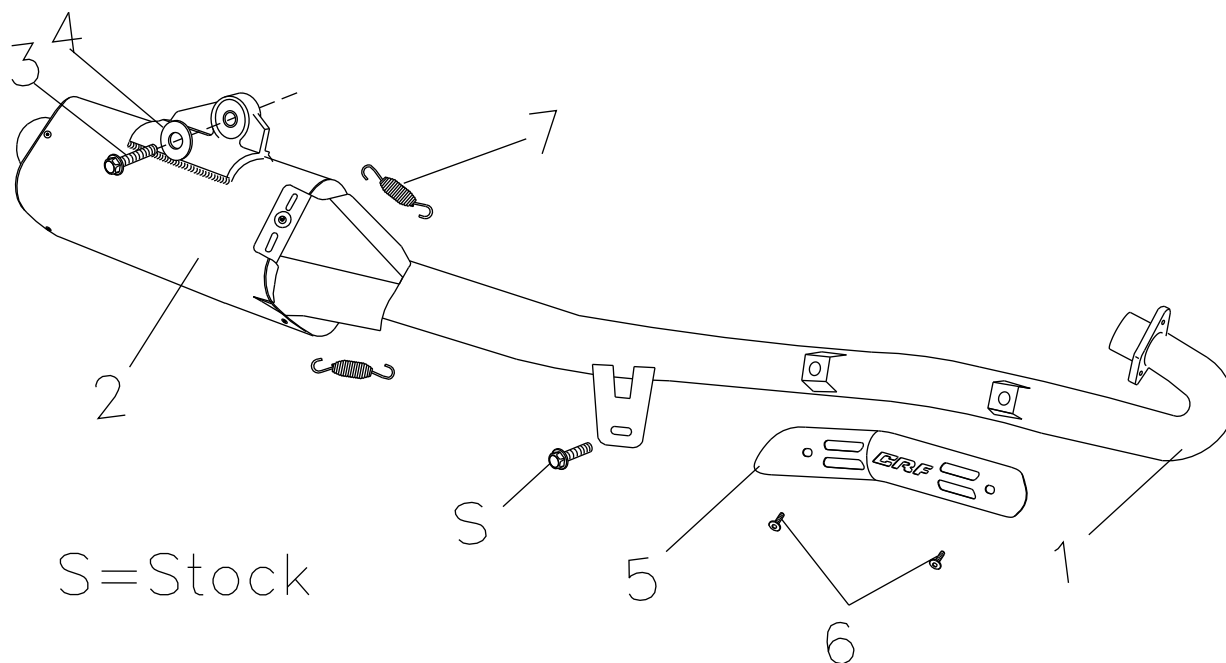

Fig. 2

#2265503



Parts Diagram

NO.	DESCRIPTION	QTY	PART #
1	Yoshimura Header & Tailpipe	1	2264-101
2	YRD Muffler Assembly	1	2264500-RMA
3	Muffler mount bolt	1	M8X35H
4	8MM Large Flat Washer	1	8MMWASHERL
5	Yoshimura Heat Shield	1	2264-HS
6	Heat Shield Bolts	2	RC116HSB
7	Springs	2	RACE-SPX-1
**	Aluminum Insert	1	ALS-006
**	Rubber Grommet	1	011257-00
**	Yoshimura Spring Puller	1	ST-200
**	Yoshimura Vinyl Sticker	2	17028-BLK

Nut and Bolt Guide (Actual Size):

8mm x 35mm
Flange Hex Bolt

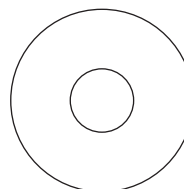
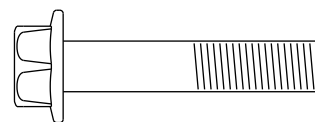

8mm Large Flat Washer



YOSHIMURA

RESEARCH&DEVELOPMENT OF AMERICA, INC.

4555 CARTER COURT, CHINO CALIF. 91710 · (800)634-9166 · (909)628-4722 · FACSIMILE (909)591-2198

www.yoshimura-rd.com

TEC-SA Spark Arrester Cleaning Information

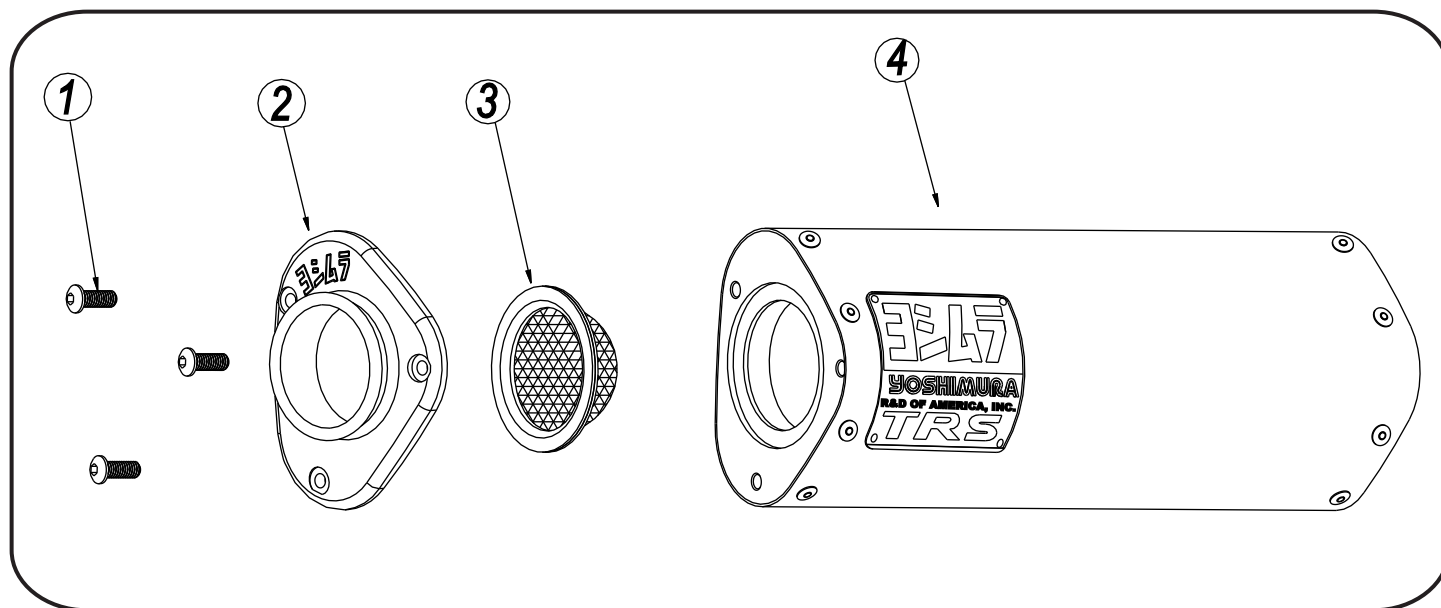

Parts Diagram

Caution: Muffler can be extremely hot. Let muffler cool down before removing spark arrester.

Note: Read through all instructions before beginning disassembly.

NO.	DESCRIPTION	QTY
1	6 x 1.0mm x 16mm Button Head Screw	3
2	Mini YRD TEC End Cap, Cover	1
3	TEC Spark Arrester Insert	1
4	Muffler Assembly	1

Tools Needed:

4mm Allen Key
Wire Brush
Pair of Gloves
Safety Glasses

Cleaning Steps:

1. Using a 4mm Allen key remove the three 6mm x 16mm Button Head Screws located in the muffler end cap. (See Parts Diagram for location)
2. Remove the end cap, gasket and spark arrester from the muffler.
3. Using a wire brush remove carbon deposits from spark arrester screen. Once clean inspect the screen for excessive wear or damage, if any is found the spark arrester must be replace. Cleaning and inspection should be performed after every 60 hours of use.
(Caution: Gloves and Safety Glasses should be worn while cleaning spark arrester.)
4. Re-install spark arrester, gasket, end cap and 6mm x 16mm screws into muffler assembly. Torque screws to 1.0 kg-m (7.3 lb-ft)
(Note: It is recommended that a low strength "Loctite" is used on the screws.)