



**FITTING INSTRUCTIONS FOR SP0076BK SWINGARM PROTECTORS**  
**SUZUKI GSX-R1000 '17-**



**THIS KIT CONTAINS THE ITEMS PICTURED AND LABELLED BELOW.**  
**DO NOT PROCEED UNTIL YOU ARE SURE ALL PARTS ARE PRESENT.**

Please note that the way the kit is packed does not necessarily represent the way of mounting to the bike.

Please note that in cases where kits are packed with a plastic tube separating components on the spindle bar (this tube should be discarded).

THE PARTS SHOWN MAY BE REPRESENTATIVE ONLY (FOR CLARITY OF INSTRUCTIONS ONLY).

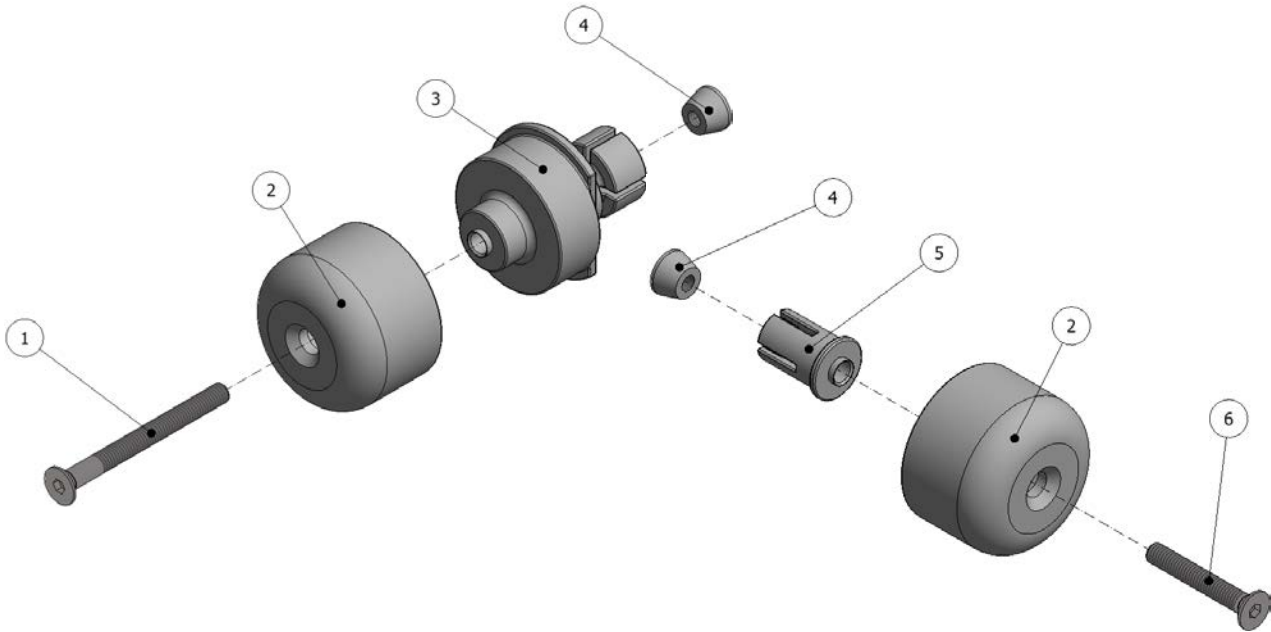

**Left Side**

**Right Side**



### **LEGEND**

- ITEM 1 = M6 x 65mm LONG COUNTERSUNK BOLT (x1).  
ITEM 2 = BOBBIN (B0481) (x2).  
ITEM 3 = MOUNTING BLOCK LEFT (M0501) (x1).  
ITEM 4 = TAPERED NUT (H0015) (x2).  
ITEM 5 = MOUNTING BLOCK RIGHT (M0354) (x1).  
ITEM 6 = M6 x 40mm LONG COUNTERSUNK BOLT (x1).

### **TOOLS REQUIRED**

- 4mm Allen key.

### **FITTING INSTRUCTIONS**

#### **Left-hand side (as you sit on bike)**

- Fit the longer counter sunk bolt (item 1) through the crash protector so head sits in counter-sink.
- Place the bobbin on to the larger mounting block (item 3 – M0501).
- Place the tapered nut (item 4 – H0015) on exposed end of bolt so tapered face goes into recess of the mounting block.
- Tighten the bolt until the tapered portion of nut just contacts in the recessed face of the mounting block.
- Place this assembly into the left hand side of the rear wheel spindle, with the machined flat profile clearing the raised boss on the chain adjuster block.
- Tighten the bolt so the bobbin is held in position firmly (do not over tighten).

#### **Right-hand side (as you sit on bike)**

- Fit the shorter counter sunk bolt (item 7) through the crash protector so head sits in counter-sink.
- Place the remaining bobbin on to the smaller mounting block (item 5 – M0354).
- Place the tapered nut (item 4 – H0015) on exposed end of bolt so tapered face goes into recess of the mounting block.
- Tighten the bolt until the tapered portion of nut just contacts in the recessed face of the mounting block.
- Place this assembly into the right hand side of the rear wheel spindle.
- Tighten the bolt so the bobbin is held in position firmly (do not over tighten).
- **Regularly check to ensure bobbins remain tight.**

ISSUE 1 12/05/2017 (AR)

#### **CONSUMER NOTICE**

The catalogue description and any exhibition of samples are only broad indications of the Products and R&G may make design changes which do not diminish their performance or visual appeal and supplying them in such state shall conform to the order. The Buyer acknowledges no representation or warranty (other than as to title) has been given or will apply to the Products other than those in R&G's order or confirmation and the Buyer confirms it has chosen the Products as being of merchantable quality and suitable for its particular purposes. Where R&G fits the Products or undertakes other services it shall exercise reasonable skill and care and rectify any fault free of charge unless the workmanship has been disturbed. The Buyer is responsible for ensuring that the warranty on the motorcycle is not affected by the fitting of the Products. On return of any defective Products R&G shall at its option either supply a replacement or refund the purchase money but shall not be liable if the Products have been modified or used or maintained otherwise than in accordance with R&G's or manufacturer's instructions and good engineering practice or if the defect arises from accident or neglect. Other than identified above and subject to R&G not limiting its liability for causing death and personal injury, it shall not be liable for indirect or consequential loss and otherwise its liability shall be limited to the amounts paid by the Buyer for the Products or the fitting or service concerned. These terms do not affect the Buyer's statutory rights.

#### **R&G RACING RETURNS POLICY (NON-FAULTY GOODS)**

Returns must be pre-authorized (if not pre-authorized the return will be rejected). Goods may only be returned direct to us if they were purchased direct from us (customer must prove if necessary). Otherwise to be returned to original vendor. Goods must be in re-sellable condition, in the opinion of R&G Racing. All returns are subject to a 25% restocking and handling fee (25% of the gross value exc. P&P – at the prevailing price at time of purchase). The customer must pay any and all carriage charges. No returns of discontinued products, unless within 14 days of purchase. This policy does not affect your statutory rights and does not refer to faulty goods.



**NOTICE DE MONTAGE POUR SP0076BK PROTECTIONS BRAS OSCILLANT  
SUZUKI GSX-R1000 '17-**



**LE KIT CONTIENT LES ARTICLES EXPOSES CI-DESSOUS, VERIFIER QUE TOUTES LES PIECES SOIENT  
PRESENTEES AVANT DE PROCEDER AU MONTAGE.**

**LA FAÇON DONT LE KIT EST EMBALLE NE CORRESPOND PAS FORCEMENT A LA FAÇON DE MONTER LES  
PIECES SUR LA MOTO.**

Notez que si les kits sont emballés avec un tube en plastic qui sépare les composants sur l'axe, ce tube doit être jeté).

LES PARTIES PRESENTEES PEUVENT ETRE UNIQUEMENT REPRESENTATIVES (POUR LA CLARTE DES INSTRUCTIONS UNIQUEMENT).

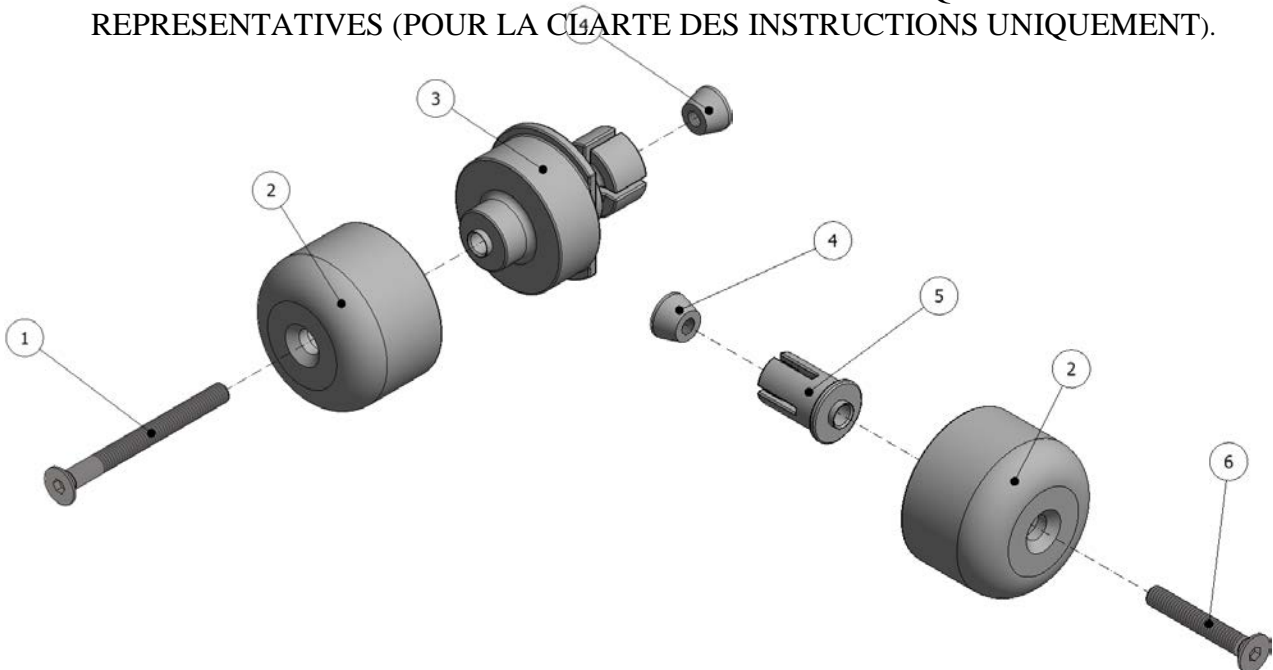

**Coté gauche**

**Coté droit**



### **LEGENDE**

- ARTICLE 1 = M6 x 65mm BOULON (x1).  
ARTICLE 2 = BOBINE (B0481) (x2).  
ARTICLE 3 = BLOC DE FIXATION COTE GAUCHE (M0501) (x1).  
ARTICLE 4 = ECROU CONIQUE (H0015) (x2).  
ARTICLE 5 = BLOC DE MONTAGE DROIT (M0354) (x1).  
ARTICLE 6 = M6 x 40mm BOULON (x1).

### **OUTIL REQUIS**

- Clé Allen 4mm.

### **NOTICE DE MONTAGE**

#### **Coté gauche (assis sur la moto)**

- Insérer le boulon (article 1) dans la protection crash de façon à ce que la tête se place dans le contre alésage.
- Placer la bobine sur le bloc de fixation plus large (article 3 – M0501).
- Placer l'écrou conique (article 4 – H0015) sur l'extrémité du boulon de façon à ce que la face conique se place dans le creux du bloc de fixation.
- Serrer le boulon jusqu'à ce que la portion conique de l'écrou entre en contact avec le creux du bloc de fixation.
- Placer cet ensemble du côté gauche de l'axe de roue arrière, avec le profile plat usiné espacé du patron relevé sur le bloc d'ajusteur de chaîne.
- Serrer le boulon de façon à ce que la bobine soit correctement fixée en position (ne pas trop serrer).

#### **Coté droit (assis sur la moto)**

- Insérer le boulon plus court (article 7) dans la protection crash de façon à ce que la tête se place dans le contre alésage.
- Placer la bobine restante sur le bloc de fixation plus petit (article 5 – M0354).
- Placer l'écrou conique (article 4 – H0015) sur l'extrémité du boulon de façon à ce que la face conique se place dans le creux du bloc de fixation.
- Serrer le boulon jusqu'à ce que la portion conique de l'écrou entre en contact avec le creux du bloc de fixation.
- Placer cet ensemble du côté droit de l'axe de roue arrière.
- Serrer le boulon de façon à ce que la bobine soit correctement fixée en position (ne pas trop serrer).
- **Vérifier régulièrement le serrage de la bobine.**

ISSUE 1 12/05/2017 (AR)

#### **CONSUMER NOTICE**

The catalogue description and any exhibition of samples are only broad indications of the Products and R&G may make design changes which do not diminish their performance or visual appeal and supplying them in such state shall conform to the order. The Buyer acknowledges no representation or warranty (other than as to title) has been given or will apply to the Products other than those in R&G's order or confirmation and the Buyer confirms it has chosen the Products as being of merchantable quality and suitable for its particular purposes. Where R&G fits the Products or undertakes other services it shall exercise reasonable skill and care and rectify any fault free of charge unless the workmanship has been disturbed. The Buyer is responsible for ensuring that the warranty on the motorcycle is not affected by the fitting of the Products. On return of any defective Products R&G shall at its option either supply a replacement or refund the purchase money but shall not be liable if the Products have been modified or used or maintained otherwise than in accordance with R&G's or manufacturer's instructions and good engineering practice or if the defect arises from accident or neglect. Other than identified above and subject to R&G not limiting its liability for causing death and personal injury, it shall not be liable for indirect or consequential loss and otherwise its liability shall be limited to the amounts paid by the Buyer for the Products or the fitting or service concerned. These terms do not affect the Buyer's statutory rights.

#### **R&G RACING RETURNS POLICY (NON-FAULTY GOODS)**

Returns must be pre-authorised (if not pre-authorised the return will be rejected). Goods may only be returned direct to us if they were purchased direct from us (customer must prove if necessary). Otherwise to be returned to original vendor. Goods must be in re-sellable condition, in the opinion of R&G Racing. All returns are subject to a 25% restocking and handling fee (25% of the gross value exc. P&P – at the prevailing price at time of purchase). The customer must pay any and all carriage charges. No returns of discontinued products, unless within 14 days of purchase. This policy does not affect your statutory rights and does not refer to faulty goods.

R&G Racing

Unit 1, Shelley's Lane, East Worldham, Alton, Hampshire, GU34 3AQ

Tel: +44 (0)1420 89007 Fax: +44 (0)1420 87301 [www.rg-racing.com](http://www.rg-racing.com) Email: [info@rg-racing.com](mailto:info@rg-racing.com)