

# HYPERPRO

## LOWERING KIT / VERLAGINGSSET for YAMAHA XT660Z Tenere Models 2008>

### LK-YA06-013-40 PART LIST

|   |   |
|---|---|
| PR121400 - Pull rod/ trekstang          | 2 |
| SL144415 - Stroke limiter/ slagbeperker | 1 |
| Bolt M6x12 B - Bolt/ bout               | 2 |
| -                                       | - |

ALL IDEAS, DESIGNS ARRANGEMENTS AND PLANS INDICATED OR REPRESENTED BY THIS DRAWING ARE OWNED BY HYPERPRO AND WERE CREATED, EVOLVED AND DEVELOPED FOR USE ON AND IN CONNECTION WITH THE SPECIFIC PROJECT. NONE SUCH IDEAS, DESIGNS, ARRANGEMENTS OR PLANS SHALL BE USED BY OR DISCLOSED TO ANY PERSON, FIRM OR CORPORATION FOR ANY PURPOSE WHATSOEVER WITHOUT THE WRITTEN PERMISSION OF HYPERPRO.

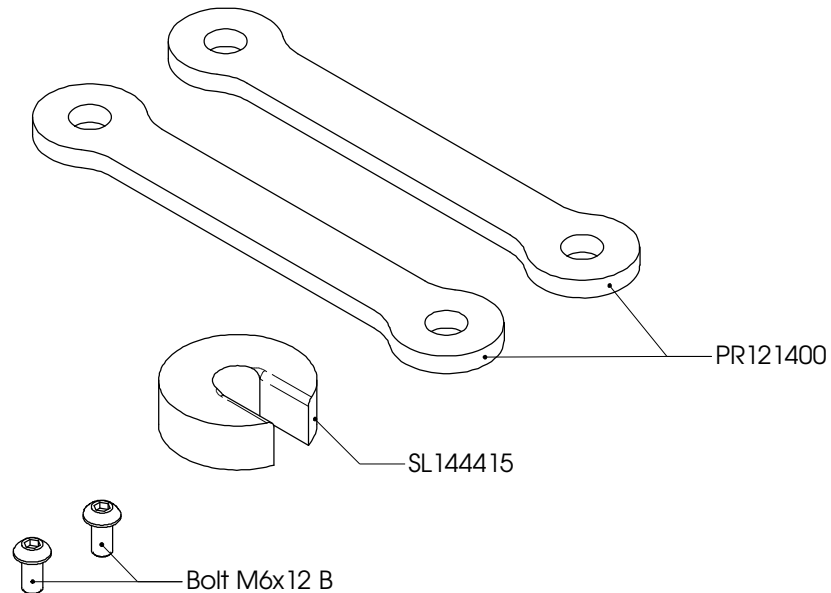

### Inbouw handleiding

#### VOORZIJDJE

De vorkpoten maximaal 40mm door de bovenste kroonplaat heen steken.  
Verwijder het "sleepoog" van de onderzijde van de onderste kroonplaat. Gebruik de mee-geleverde M6x12 bouten om de remleidingen weer te bevestigen aan de kroonplaat.

#### ACHTERZIJDJE

De bestaande link vervangen door de HYPERPRO verlagingslink.  
De slagbeperker boven op het aanslagrubber van de schokbreker plaatsen.  
Het achterwiel eerst belasten voordat de link vastgezet wordt.

LET OP! DE LENGTE VAN DE ZIJSTANDAARD MOET 20-25mm INGEKORT WORDEN.

### Instruction manual

#### FRONT

Mount the fork legs max 40mm through the triple clamp.  
Remove the "towing hook" from the bottom of the lower triple clamp. Use the supplied M6x12 bolts to re-mount the brake lines to the lower triple clamp.

#### REAR

Replace the original link by the HYPERPRO lowering link.  
Put the stroke limiter on top of the bump rubber of the shock.  
Put some pressure on the rear wheel before tightening the link.

WARNING! SHORTEN THE SIDE-STAND 20-25mm.

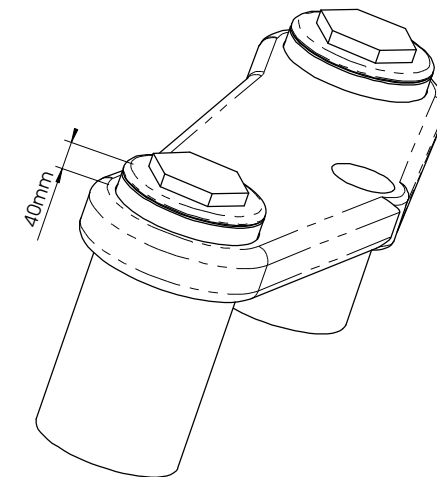

See [WWW.HYPERPRO.COM](http://WWW.HYPERPRO.COM) for more info about our products.