

**WARNING! EC TYPE APPROVAL IS NOT VALID
WHEN OPTIONAL VALVE SYSTEM IS INSTALLED!**

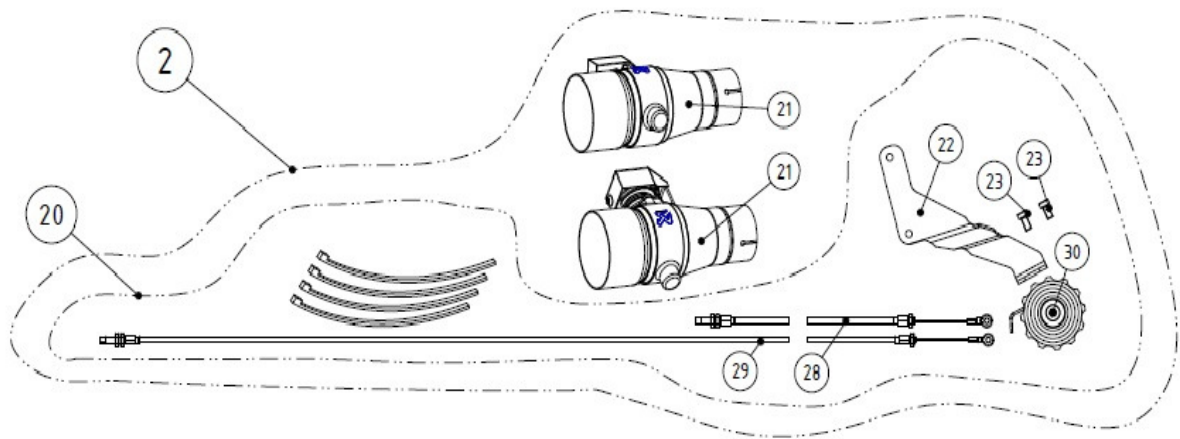

No.	SALES CODE	DESCRIPTION	QTY.
2	P-HDV6/1	valve set	1
20	P-HF602	fitting kit	1
21	LP-HDST2/1	link pipe with valve	2
22	P-X76	bracket SS	1
23	P-FB31	bolt	2
28	P-HF630	cable wire L=1210mm	1
29	P-HF631	braids exup valve	1
30	P-HF639	switch	1