

## YAMAHA YZF-R1/YZF-R1M(15-) SILENCER BRACKET SET



Be sure to read the instruction carefully before starting the work. It is necessary to follow the contents to install this product.

**CAUTION** Before beginning installation, let motorcycle cool down.

**CAUTION** During the work, be careful not to damage each parts. Especially, Heat Shield is coated with black paint. Handle with care not to be hit or scratched by surroundings as the coating may come off.

**CAUTION** Torque specification must be followed. If neglected, it may cause bolt and nut to fell off and damage to Yoshimura exhaust and motorcycle.

### 1. Product Information:

Description	YAMAHA YZF-R1/YZF-R1M Silencer Bracket Set	Application	YAMAHA YZF-R1/YZF-R1M (15-)
Part Number	194-38A-0010	Main Material	Aluminum

### 2. Contents:

No.	Descriptions	Part No.	Q'ty
1	Silencer Bracket S	161-38A-0220	1
2	Silencer Bracket L	161-38A-0230	1
3	Flange Nut M8	823-008-1250	2

### Parts Diagram

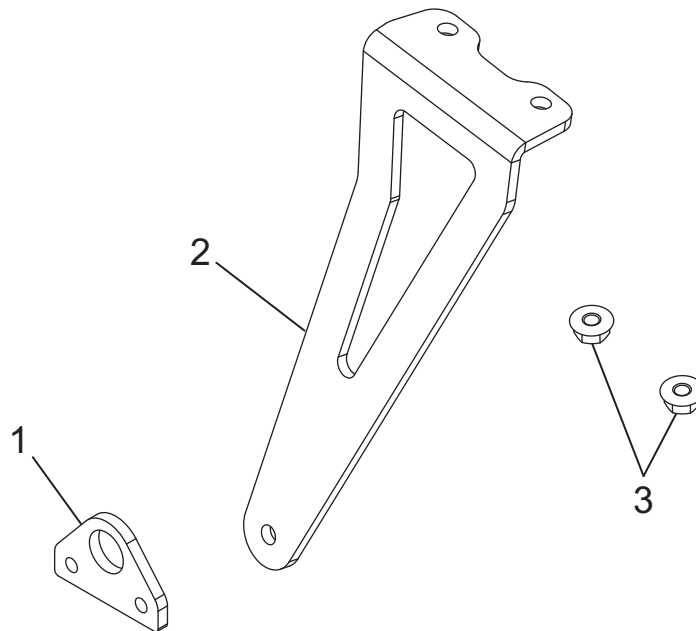

### 3. INSTALLATION STEPS :

1) Check all the component parts are in hand.