



YOSHIMURA

RESEARCH&DEVELOPMENT OF AMERICA, INC.

5420 DANIELS STREET STE A, CHINO CA., 91710 · (800) 634-9166 · (909) 628-4722 · FAX (909) 591-2198

www.yoshimura-rd.com

Street Series

Qualified Manufacturer Declared "Replacement Part"

2017~2019

CBR-1000RR

12202BP520 (SS/CF)

12202MP720 (TI/CF)

Alpha Taper Slip-On

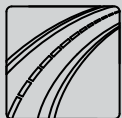

All Street Series systems are:

- Slip-on/Bolt-on applications that do not require tampering with the vehicle's emissions control system.
- CARB/EPA tail-pipe emissions compliant.
- Marked with appropriate EPA noise labels.
- Not tested for EPA new vehicle noise compliance.



✘ You must know how to remove and replace your stock exhaust in order to install this product otherwise have it installed by a professional mechanic. Keep all stock parts from your existing system as some components may be necessary to install your new Yoshimura exhaust depending on the application. Read through all instructions before beginning installation. Exhaust system can be extremely hot. Let motorcycle cool down before beginning installation. Always wear hand and eye protection and take precautionary measures to avoid injury. ✘

NOTE: IN THE STATE OF CALIFORNIA, IT IS ILLEGAL TO MODIFY THE EMISSION CONTROL SYSTEM, WHICH INCLUDES THE CARBURETORS OF ANY VEHICLE.

Assembly Diagram

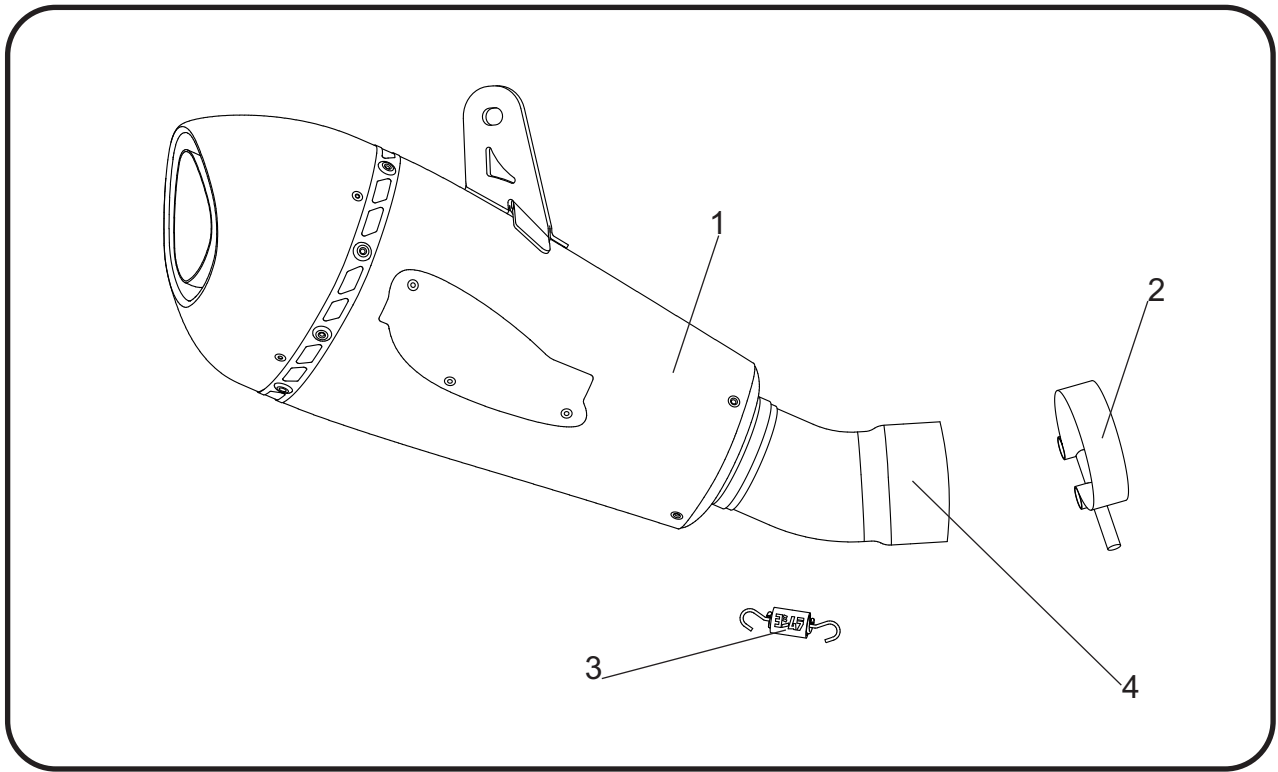

No.	Item	Description	Qty.
1	12202BP520RMA 12202MP720RMA	Yoshimura Stainless Steel Muffler Yoshimura Titanium Muffler	1
2	20067	Collector Clamp	1
3	RACE-SPX-1	Small Spring	1
4	12202-435D 12202-735D	Stainless Steel Tailpipe Titanium Tailpipe	1
**	ST-200	Spring Puller Tool	1
**	INS-27-K	Alpha Sound Insert Kit	1
**	17029	Yoshimura Sticker Kit	1

** Not shown in diagram.

CAUTION: Exhaust system can be extremely hot. Let motorcycle cool down before beginning installation. Always wear hand and eye protection and take precautionary measures to avoid injury.

WARNING: Always properly support vehicle with a stand and/or lift when servicing or performing any work. Unstable vehicles may present dangerous conditions and may cause property damage and/or personal injury.

NOTE: Read through all instructions before beginning installation.

Removal

1. Remove lower right fairing as per Factory Service / Owners Manual.
2. Disconnect and remove exhaust valve cables from the muffler assembly.

Note: Exhaust valve cables will not be used with the Yoshimura Slip-On. Remove exhaust valve cables from servo motor. Do not disconnect servo motor connector.

3. Loosen the stock exhaust clamp. While securely supporting the muffler, remove the muffler mount bolt and carefully remove the stock muffler assembly.

Note¹: The stock exhaust clamp will not be used with Yoshimura Slip-On.

Note²: The stock muffler mount bolt will be re-used Yoshimura Slip-On.

Installation

1. Slide (No. 2) 20067 collector clamp over (No. 4) 12202-435D/735D Yoshimura Tailpipe. Install (No. 1) muffler, onto the stock header outlet and align muffler bracket to the backside of the stock muffler mount bracket as shown below.

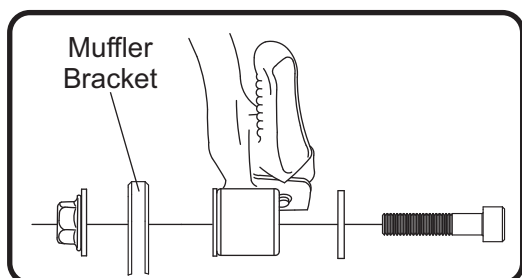

2. Secure (No. 1) muffler, using the stock muffler mount bolt. Do not torque at this time.
3. Install (No. 3) RACE-SPX-1 in-between (No. 1) muffler and (No.4) 12202-435D/735D tailpipe as shown below.

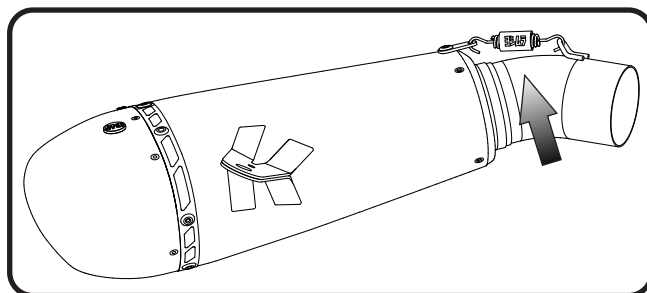

4. Torque (No. 2) 20067 exhaust clamp to 8.5 Nm (0.86 kg-m, 6 ft-lb).
5. Torque muffler mount bolt to factory specification.
6. Re-install the lower right fairing.
7. Before starting vehicle, check for proper clearance between new exhaust system and rear suspension (i.e. tire, swingarm, brakes, rear shock, and etc.) If any problem is found, please carefully follow through the installation steps again. If problem still persists, please call Yoshimura Tech Department at (800) 634-9166 / in CA (909) 628-4722.
8. It is recommended that the muffler and tailpipe be wiped down with rubbing alcohol to remove oil and fingerprints. This will help prevent tarnishing of the finish after the exhaust is heated up.

Works Finish Care & Maintenance

Before starting vehicle, clean pipe thoroughly using a soft cloth and rubbing alcohol to remove any oil and finger prints.

The color of the exhaust will change once the system has gone through a heat cycle of 15 minutes or more. Color will vary depending on lean/rich conditions.

Clean using a soft cloth and soap. Do not use abrasive materials as it will scratch the surface.

Surface reconditioning services are available to remove scratches and undesirable discoloration due to extreme heat. Contact Yoshimura Tech Department at (800) 634-9166 / in CA (909) 628-4722 for more information.