



YOSHIMURA

RESEARCH & DEVELOPMENT OF AMERICA, INC.

5420 DANIELS STREET STE A, CHINO CA 91710 · (800) 634-9166 · (909) 628-4722 · FAX (909) 591-2198

WWW.YOSHIMURA-RD.COM

Signature Series

Qualified Manufacturer Declared "Replacement Part"

**2003~2014
Suzuki
LT-Z400**

**2003~2006
Kawasaki
KFX 400**

**2003~2008
Arctic Cat
DVX 400**

**2176703 (AL/SS)
RS-2 Stainless Steel Slip-On**



Signature Series systems are:

- CARB/EPA tail-pipe emissions compliant.
- Marked with appropriate EPA noise labels.
- Independent laboratory tested for EPA new vehicle noise compliance.

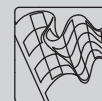

CAUTION: The muffler packing on this system **MUST** be replaced every 6-8 hours of use, or every 1-2 motos. Failure to follow recommended muffler re-packing interval can cause muffler damage and may void the warranty.



NOTE: IN THE STATE OF CALIFORNIA, IT IS ILLEGAL TO MODIFY THE EMISSION CONTROL SYSTEM, WHICH INCLUDES THE FUEL INJECTION OF ANY VEHICLE.

Caution: Exhaust system can be extremely hot. Let motorcycle cool down before beginning installation. Always wear hand and eye protection and take precautionary measures to avoid injury.

Note: Read through all instructions before beginning installation.

Tools Needed:

Metric sockets
Ratchet and extension
Metric combination wrench set
Metric Allen Bit Set for ratchet
Torque wrench
Suzuki Service Manual

Installation Steps:

- 1 Remove stock muffler. (See Fig. 1)
- 2 Insert supplied rubber grommet into muffler mounting bracket. Insert supplied aluminum spacer into the inside of the rubber grommet. (See parts diagram for orientation.)
- 3 Inspect stock gasket. If there is excessive wear or damage replace with supplied gasket. Insert stock exhaust gasket into Yoshimura tailpipe. Slip supplied collector clamp onto Yoshimura tailpipe then install Yoshimura tailpipe with muffler onto stock header.
- 4 Mount muffler to upper chassis mount. Mounting orientation is as follows: Supplied bolt, washer, muffler mounting bracket w/ rubber grommet, aluminum spacer, aluminum spacer, frame. (See parts diagram for orientation.) Do not torque at this time.
- 5 Torque collector clamp to 2.0 kg-m (14.6 lb-ft)
- 6 Torque muffler mounting bolt to 2.5 kg-m (18 lb-ft).
- 7 It is recommended that the entire exhaust system be wiped down with rubbing alcohol to remove oil and fingerprints. This will help prevent tarnishing of the finish after the exhaust is heated up.
- 8 Before starting motorcycle check for proper clearance between new exhaust system and motorcycle. (i.e. rear brake, frame, tire, etc.) If any problem is found, please carefully follow through the installation steps again. If problem still persists, please call Yoshimura tech. Dept. At (800)634-9166 / in CA (909)628-4722

NOTE: After starting motorcycle, it is normal for new exhaust system to emit smoke until oil residue burns off

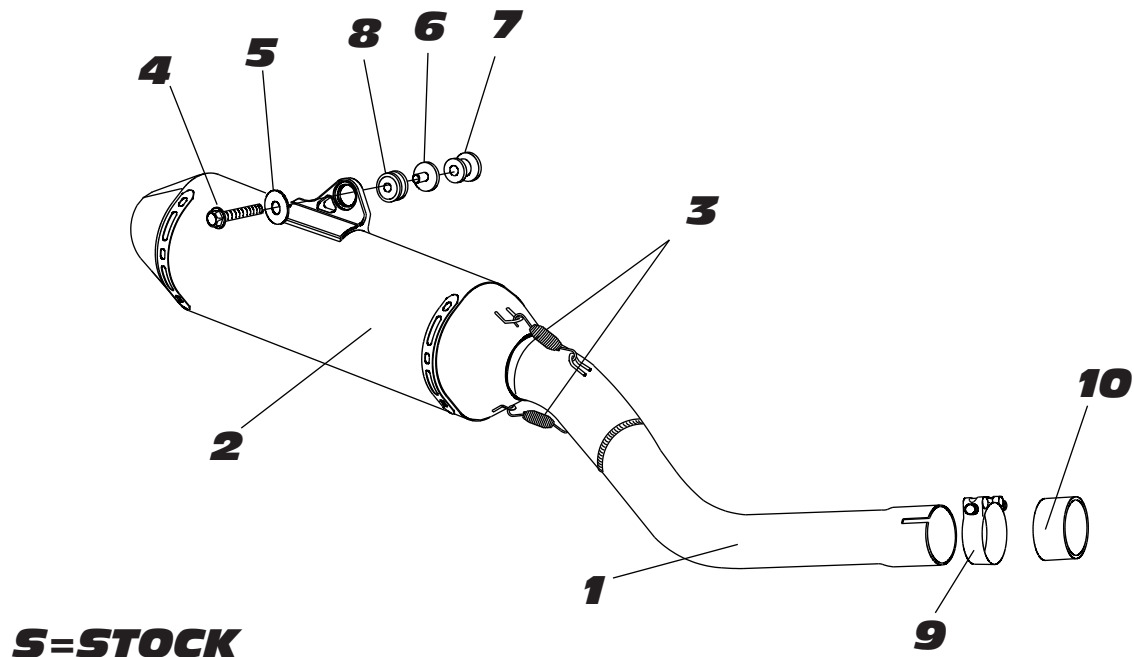

Fig. 1



Fig. 2

#2176703



Parts Diagram

| NO. | DESCRIPTION | QTY | PART # |
|-----|--|-----|-------------|
| 1 | Yoshimura Slip-on Tailpipe Stainless Steel Race | 1 | 2176-152 |
| 2 | RS2 Offroad Muffler Assembly | 1 | 2176503-RMA |
| 3 | Exhaust Spring Medium | 2 | RACE-SPS-1 |
| 4 | 8mm X 55mm Flanged Hex Head Bolt | 1 | M8X55H |
| 5 | Large Washer | 1 | 8MMWASHERL |
| 6 | Aluminum Spacer | 1 | ALS-003 |
| 7 | 8mm X 26mm Aluminum Spacer | 1 | 8X26SPCR |
| 8 | Rubber Grommet | 1 | Z1022 |
| 9 | 220-59 Collector Clamp | 1 | 22059 |
| 10 | Muffler Gasket | 1 | 16-5565 |
| ** | Spring Puller Tool | 1 | ST-200 |
| ** | Offroad Endcap Plug | 1 | 347PLUG |
| ** | Yoshimura Vinyl Sticker | 1 | 17029 |



YOSHIMURA

RESEARCH & DEVELOPMENT OF AMERICA, INC.

5420 DANIELS STREET SUITE A, CHINO, CA 91710 · (800)634-9166 · (909)628-4722 · FACSIMILE (909)591-2198

www.yoshimura-rd.com

Spark Arrester Cleaning Information

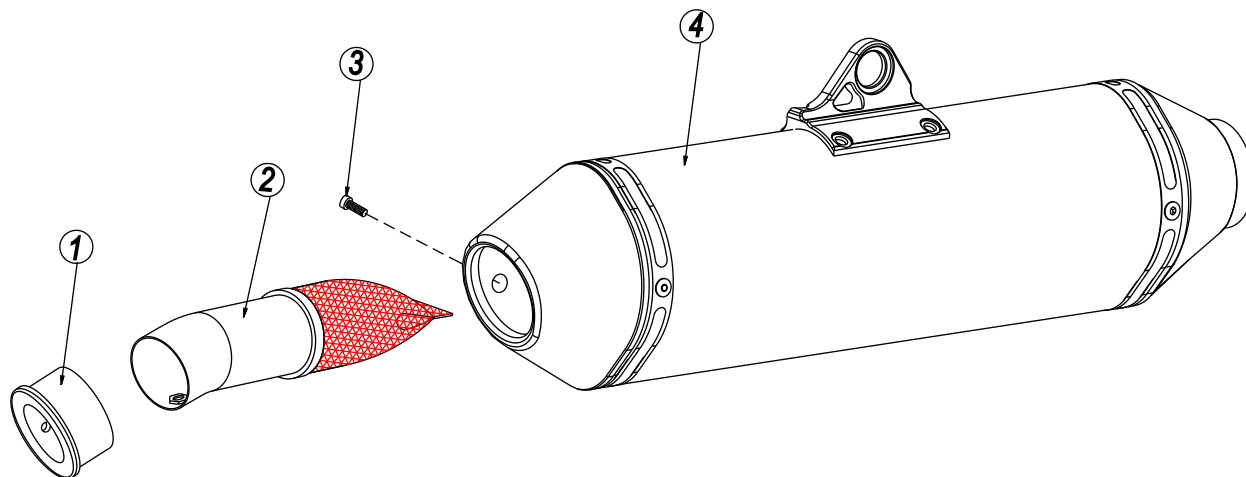

Caution: *Muffler can be extremely hot. Let muffler cool down before removing spark arrester.*

Note: *Read through all instructions before beginning disassembly.*

Tools Needed:

4mm Allen Key
Wire Brush
Pair of Gloves
Safety Glasses

Cleaning Steps:

- 1 Using a 4mm Allen key, remove the bolt that secures the aluminum ring and spark arrester to the muffler (see Parts Diagram for location).
- 2 Remove the spark arrester from the muffler.

Parts Diagram

| NO. | DESCRIPTION | QTY |
|-----|------------------------------|-----|
| 1 | Aluminum Ring | 1 |
| 2 | Spark Arrester | 1 |
| 3 | Spark Arrester Securing Bolt | 1 |
| 4 | Muffler Assembly | 1 |

- 3 Using a wire brush, remove carbon deposits from spark arrester screen. Inspect the screen for excessive wear or damage. If spark arrester is excessively worn or damaged, the spark arrester must be replaced. Cleaning and inspection should be performed at the same time as muffler repacking. Muffler repacking is recommended every 8-10 hours or 2 motos, whichever comes first.

CAUTION: Gloves and safety glasses should be worn while cleaning spark arrester.

- 4 Re-install spark arrester and aluminum ring. Torque the spark arrester securing bolt to 1.0 kg-m (7.3 lb-ft).

NOTE: It is recommended that a low strength "Loc-tite" is used on the spark arrester securing bolt.