



YOSHIMURA

RESEARCH & DEVELOPMENT OF AMERICA, INC.

5420 DANIELS STREET STE A, CHINO CA 91710 · (800) 634-9166 · (909) 628-4722 · FAX (909) 591-2198

WWW.YOSHIMURA-RD.COM

Signature Series

Qualified Manufacturer Declared "Replacement Part"

2010~2018

SUZUKI RM-Z250

2183172 (CF/CF)

2183177 (Ti/CF)

RS-4 Titanium Full-System



Signature Series systems are:

- CARB/EPA tail-pipe emissions compliant.
- Marked with appropriate EPA noise labels.
- Independent laboratory tested for EPA new vehicle noise compliance.

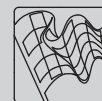

CAUTION: The muffler packing on this system **MUST** be replaced every 6-8 hours of use, or every 1-2 motos. Failure to follow recommended muffler re-packing interval can cause muffler damage and may void the warranty.



NOTE: IN THE STATE OF CALIFORNIA, IT IS ILLEGAL TO MODIFY THE EMISSION CONTROL SYSTEM, WHICH INCLUDES THE FUEL INJECTION OF ANY VEHICLE.

Caution: Exhaust system may be extremely hot. Let motorcycle cool down before beginning installation.

Note: Read through all instructions before beginning installation.

Tools Needed:

Metric Socket Set
Ratchet Wrench and Extension
Torque Wrench
Spring Puller Tool
Hex Key Set

Installation Steps:

1 Stock Exhaust Removal

- Remove right rear number plate (see Fig. 1 for fastener locations).
- Loosen stock muffler clamp.
- Unbolt chassis and muffler mount bolts.
- Remove stock muffler (see Fig. 2 for fastener locations).
- Remove stock header (see Fig 3 for fastener locations).
Note: Inspect stock header gasket for damage. If damaged, replace with new stock gasket, PN: 14181-49H00.

2 Install Yoshimura Exhaust

- Install header springs onto Yoshimura flange and manifold. Mount loosely onto cylinder head using stock header bolts.
- Install Yoshimura header onto Yoshimura manifold.
- Temporarily remove tailpipe-to-muffler spring.
- Install supplied rubber grommet into aluminum muffler mounting bracket. Install aluminum insert into rubber grommet (make sure shoulder of aluminum insert faces toward the frame, see Fig. 4).
- Install Yoshimura tailpipe and muffler onto Yoshimura header.
- Mount stock chassis mount bolt to tailpipe. Leave loose.
- Mount muffler with stock muffler mount bolt and washer. Leave loose.
- Attach header springs to header and tailpipe-to-muffler spring.
- Check exhaust for proper position and clearance and adjust if necessary.
- Tighten stock header nuts to 15 ft-lb (21 N-m).
- Tighten chassis mount and muffler mount bolts to 15 ft-lb (21 N-m).



Fig. 1

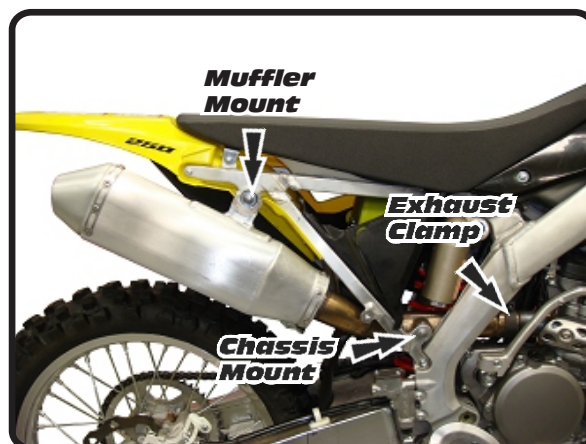

Fig. 2

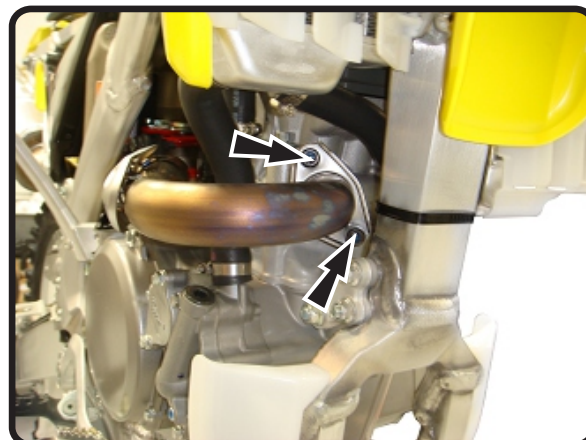

Fig. 3

3 Reinstall

a. Reinstall number plate.

b. It is recommended that the muffler and tailpipe be wiped down with rubbing alcohol to remove oil and fingerprints. This will help prevent tarnishing of the finish after the exhaust is heated up.

Before starting motorcycle, check for proper clearance between new exhaust system and rear suspension (i.e. tire, swingarm, brake, rear shock, etc). If any problem is found, please carefully repeat through the installation steps. If problem still persists, please call Yoshimura tech department at (800) 634-9166 / in CA (909) 628-4722.

NOTE: After starting motorcycle, it is normal for new exhaust system and muffler to emit smoke until oil residue burns off.

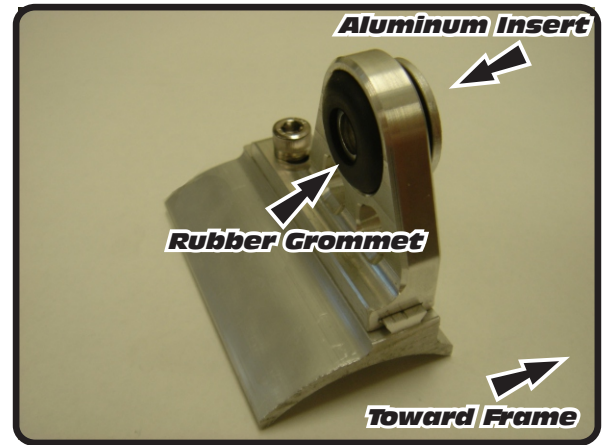
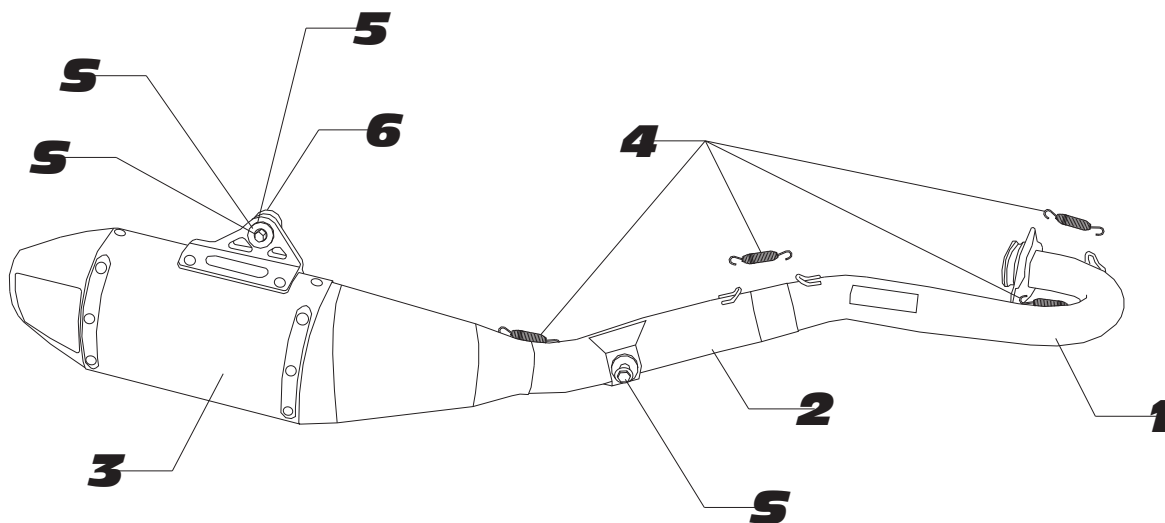

Fig. 4

PN: 218317(2,7)



S = STOCK

Parts Diagram

| NO. | DESCRIPTION | QTY | PART # |
|-----------------------------------|--|-----|----------------------------|
| 1 | Yoshimura Titanium Header | 1 | 2183-704F |
| 2 | Yoshimura Titanium Tailpipe | 1 | 2183-744 |
| 3 | Yoshimura Race Muffler with Carbon Fiber Sleeve Yoshimura Race Muffler with Titanium Sleeve | 1 | 2183172-RMA 2183177-RMA |
| 4 | Short Exhaust Spring | 4 | RACE-SPX-1 |
| 5 | Muffler Mount Rubber Grommet | 1 | Z1022 |
| 6 | Aluminum Insert | 1 | ALS-010 |
| ** | Instructions Manual | 1 | INST KIT |
| ** | Spring Puller Tool | 1 | ST-200 |
| ** | Yoshimura Vinyl Sticker | 1 | 17029 |
| ** | Muffler Wash Plug | 1 | 347PLUG |
| OPTIONAL REPLACEMENT PARTS | | | |
| | RS4 Sound Insert | | INS-14-K |
| | 2m-MAX Sound Insert | | INS-14-K |
| | Spark Arrestor | | SA-08-K |
| | Re-pack Kit | | REPACK-RS4-PK11 |