



RESEARCH & DEVELOPMENT OF AMERICA, INC.

5420 DANIELS STREET STE A, CHINO CA 91710 · (800) 634-9166 · (909) 628-4722 · FAX (909) 591-2198

WWW.YOSHIMURA-RD.COM

## *Signature Series*

Qualified Manufacturer Declared "Replacement Part"

**2008~2017**  
**Suzuki RM-Z450**

**2010~2011**  
**Suzuki RMX450Z**

**2192172 (Ti/CF)**

**2192177 (Ti/Ti)**

**RS-4 Titanium Full-System**

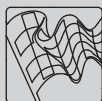

Signature Series systems are:

- CARB/EPA tail-pipe emissions compliant.
- Marked with appropriate EPA noise labels.
- Independent laboratory tested for EPA new vehicle noise compliance.

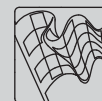

CAUTION: The muffler packing on this system **MUST** be replaced every 6-8 hours of use, or every 1-2 motos. Failure to follow recommended muffler re-packing interval can cause muffler damage and may void the warranty.



NOTE: IN THE STATE OF CALIFORNIA, IT IS ILLEGAL TO MODIFY THE EMISSION CONTROL SYSTEM, WHICH INCLUDES THE FUEL INJECTION OF ANY VEHICLE.

**Caution:** Exhaust system may be extremely hot. Let motorcycle cool down before beginning installation.

**Note:** Read through all instructions before beginning installation.

## Tools Needed:

Metric Socket Set  
Ratchet Wrench and Extension  
Torque Wrench  
Spring Puller Tool  
Rotary Cutting Tool

## Installation Steps:

### 1 Stock Exhaust Removal

- Remove right rear number plate (see Fig. 1 for fastener locations).
- Remove stock muffler (see Fig. 2 for fastener locations).
- Remove stock header (see Fig. 3 for fastener locations).
- Remove the stock exhaust port gasket and install new stock exhaust port gasket (not included).

### 2 Install Yoshimura Exhaust

- Install springs onto flange and manifold and slide onto header. Install Yoshimura header using stock header nuts. Do not tighten header nuts at this time.
- Install supplied rubber grommet into aluminum muffler mounting bracket. Install aluminum insert into rubber grommet (make sure shoulder of aluminum insert faces toward the frame, see Fig. 4).
- Install Yoshimura tailpipe and muffler onto Yoshimura header.
- Trim tail plastic as shown in figure 5. The dotted line shows where the plastic needs to be cut to clear the muffler mounting bracket
- Install supplied muffler mount bolt and supplied washer. Install stock chassis mount bolt. Leave loose.



Fig. 1

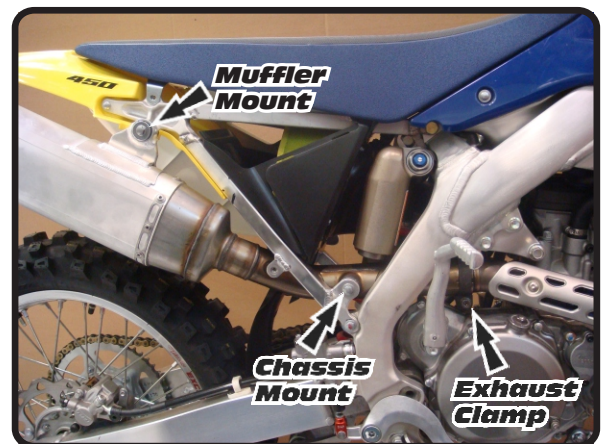

Fig. 2

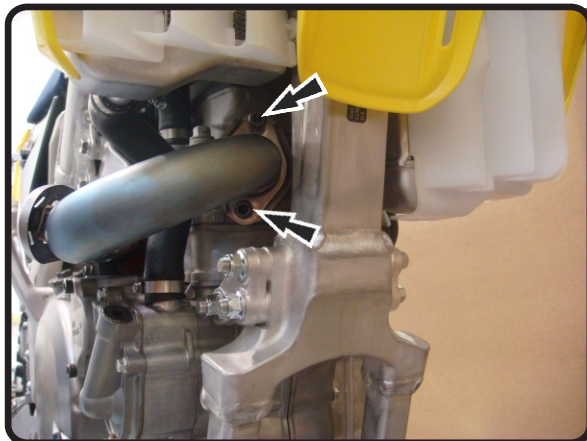

Fig. 3

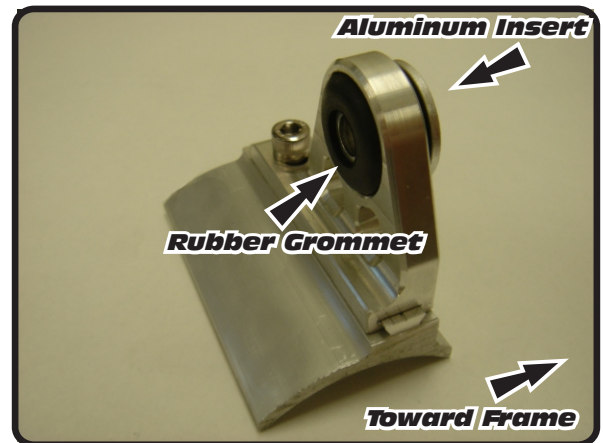
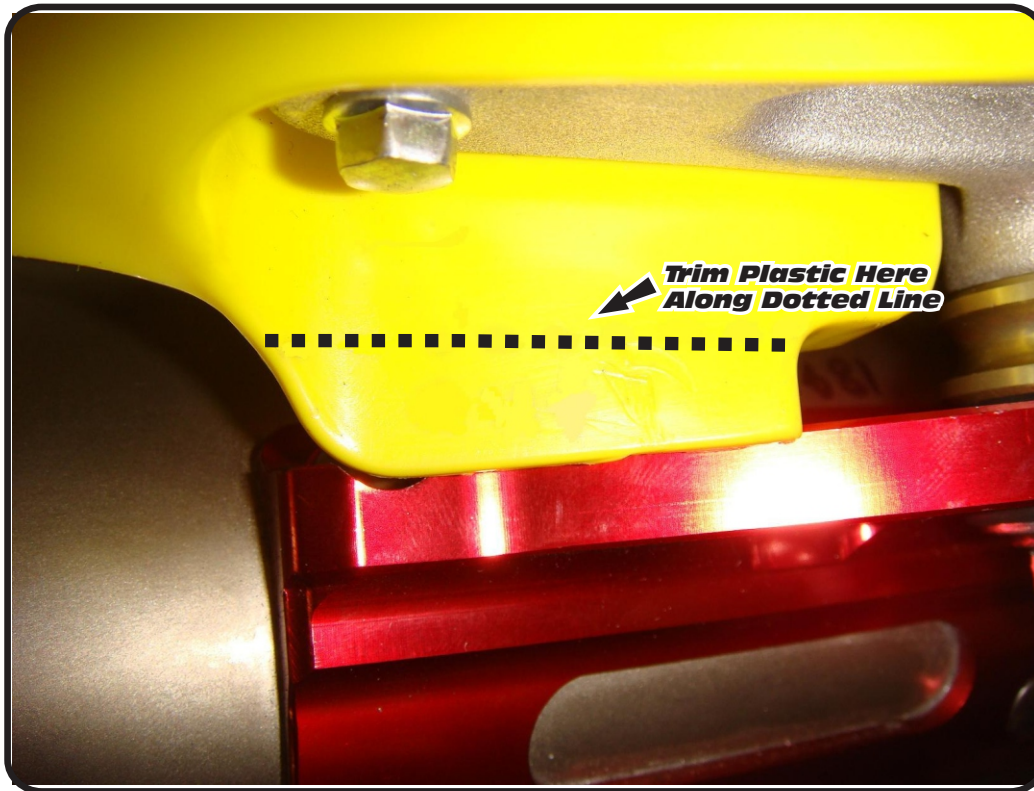

Fig. 4

**Fig. 5**

f. Check exhaust for proper position and clearance and adjust if necessary.

g. Torque header nuts to 1.25 kg-m (9 lb-ft).

h. Torque chassis mount bolt and muffler mount bolt to 2.5 kg-m (18 lb-ft).

i. It is recommended that the muffler and tailpipe be wiped down with rubbing alcohol to remove oil and fingerprints. This will help prevent tarnishing of the finish after the exhaust is heated up.

**NOTE:** Your Yoshimura exhaust system has been designed with weight centralization in mind. Trimming of the number plate is required in order to move the muffler as far forward as possible.

j. Apply the adhesive foil heatshield to the inside of the number plate as shown in figure 6. The adhesive foil heatshield will prevent the numberplate from discoloring and / or melting from the heat coming from the tailpipe and muffler.

### 3 Reinstall

a. Reinstall number plate.

Before starting motorcycle, check for proper clearance between new exhaust system and rear suspension (i.e. tire, swingarm, brake, rear shock, etc). If any problem is found, please carefully follow through the installation steps again. If problem still persists, please call Yoshimura tech department at (800) 634-9166 / in CA (909) 628-4722.

**NOTE:** After starting motorcycle, it is normal for new exhaust system and muffler to emit smoke until oil residue burns off.

**Fig. 6**



**#219217(2,7)**

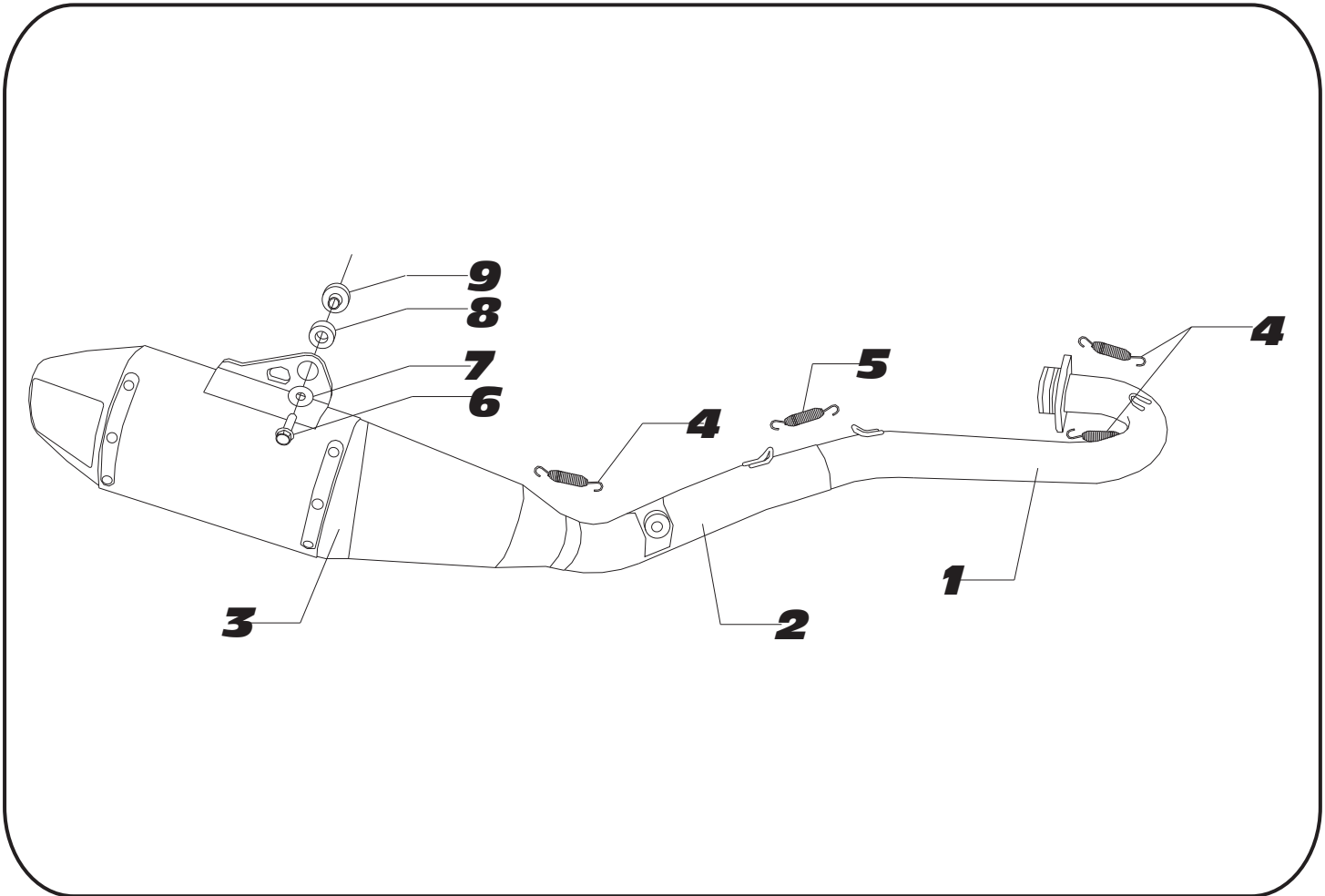

Parts Diagram

NO.	DESCRIPTION	QTY	PART #
1	Yoshimura Header	1	2191-704F
2	Yoshimura Tailpipe	1	2192-744
3	Yoshimura RS4 Race Muffler w/ Carbon Fiber Sleeve Yoshimura RS4 Race Muffler w/ Titanium Sleeve	1	2192172-RMA 2192177-RMA
4	Short Exhaust Spring	3	RACE-SPX-1
5	Medium Exhaust Spring	1	RACE-SPS-1
6	8mm x 40mm Flange Head Bolt	1	M8X40H
7	8mm Flat Washer, Large	1	8MMWASHERL
8	Muffler Mount Rubber Grommet	1	Z1022
9	Aluminum Insert	1	ALS-010
**	Adhesive Foil Heatshield	1	1200-00-01
**	Spring Puller Tool	1	ST-200
**	Yoshimura Vinyl Sticker	1	17029
**	Muffler Wash Plug	1	347PLUG
<b>OPTIONAL REPLACEMENT PARTS</b>			
	RS4 Sound Insert		INS-2M28-K
	99dB Sound Insert		INS-10-K
	2m-MAX Sound Insert		INS-2M28-K
	Spark Arrestor		SA-04-K
	Re-pack Kit		REPACK-RS4-PK11